

SECTION A-A

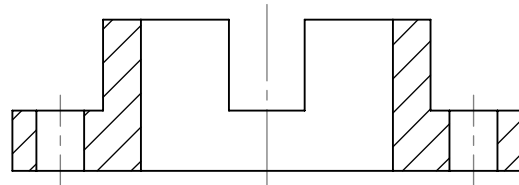

SECTION B-B

Section views are used to clarify internal features of the part.

These two section views show all internal features.

Additional orthographic views would best clarify external features, but were not asked for.

Hidden lines are not included in section views.

PROPRIETARY AND CONFIDENTIAL
 THE INFORMATION CONTAINED IN THIS DRAWING IS THE SOLE PROPERTY OF <INSERT COMPANY NAME HERE>. ANY REPRODUCTION IN PART OR AS A WHOLE WITHOUT THE WRITTEN PERMISSION OF <INSERT COMPANY NAME HERE> IS PROHIBITED.

		UNLESS OTHERWISE SPECIFIED:		NAME	DATE		
		DIMENSIONS ARE IN INCHES TOLERANCES: FRACTIONAL ± ANGULAR: MACH ± BEND ± TWO PLACE DECIMAL ± THREE PLACE DECIMAL ±		DRAWN		TITLE:	
		INTERPRET GEOMETRIC TOLERANCING PER:		CHECKED			
		MATERIAL		ENG APPR.			
		FINISH		MFG APPR.			
NEXT ASSY		USED ON		Q.A.			
APPLICATION		DO NOT SCALE DRAWING		COMMENTS:			
				SIZE	DWG. NO.	REV	
				A Problem 1			
				SCALE: 1:2	WEIGHT:	SHEET 1 OF 1	

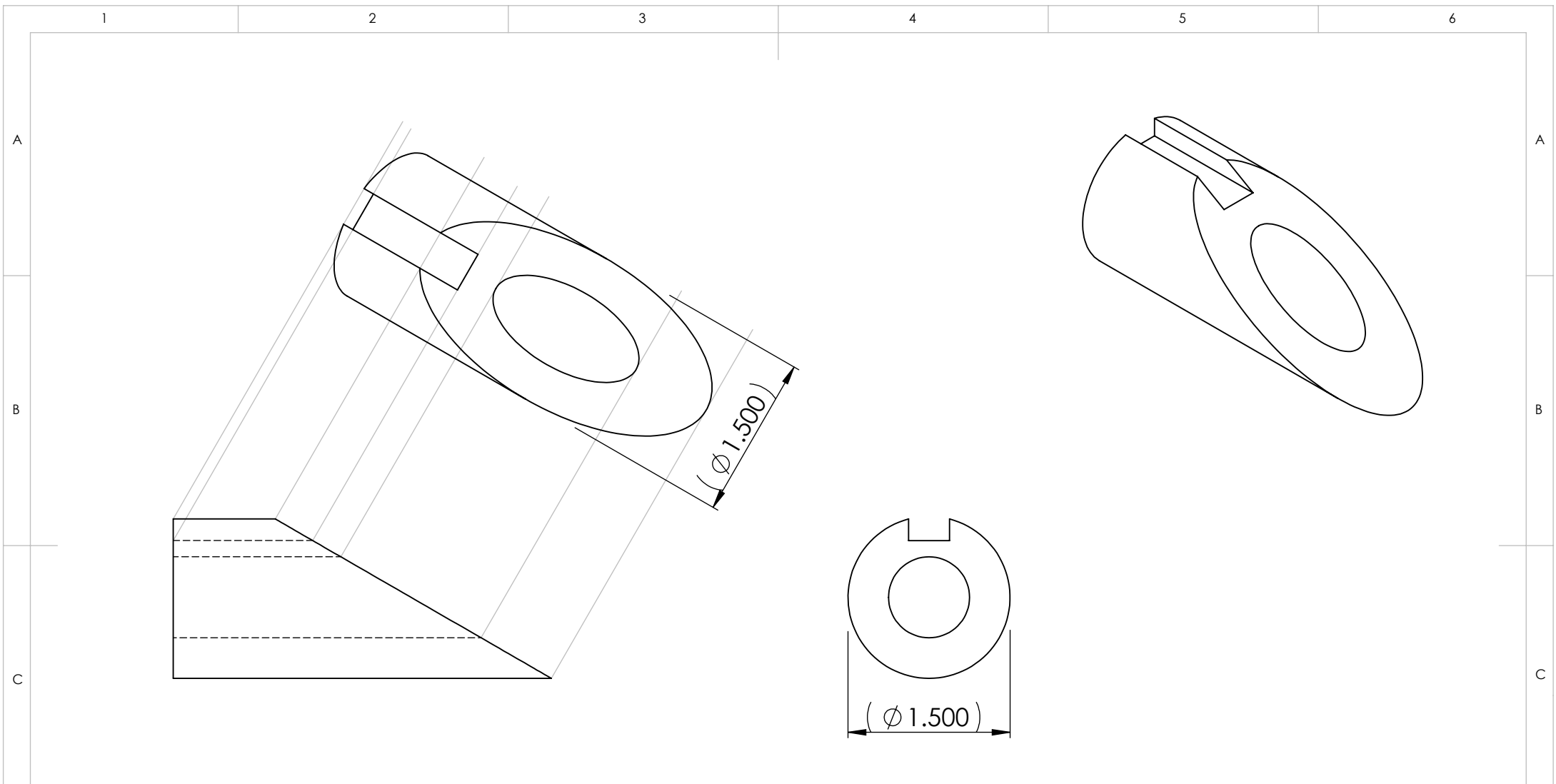

UNLESS OTHERWISE SPECIFIED: DIMENSIONS ARE IN MILLIMETERS SURFACE FINISH: TOLERANCES: LINEAR: ANGULAR:				FINISH:		DEBUR AND BREAK SHARP EDGES		DO NOT SCALE DRAWING		REVISION	
	NAME	SIGNATURE	DATE					TITLE: <h1>test2</h1>			
DRAWN											
CHK'D											
APPV'D											
MFG											
Q.A				MATERIAL:			DWG NO.		<h1>Problem2</h1>		A4
				WEIGHT:			SCALE:20:1		SHEET 1 OF 1		

Line AC is in True Length in Views 1,3 and 4.
 1. Find the missing points in each view given
 2. Is there a plane in which 4 (or more) points lie within?
 If so, which 4 points?
 3. In which views is there a plane in true view? Which
 points define these planes?

2. yes, ACDE
 3. ACDE in view 4, ACF in view 3

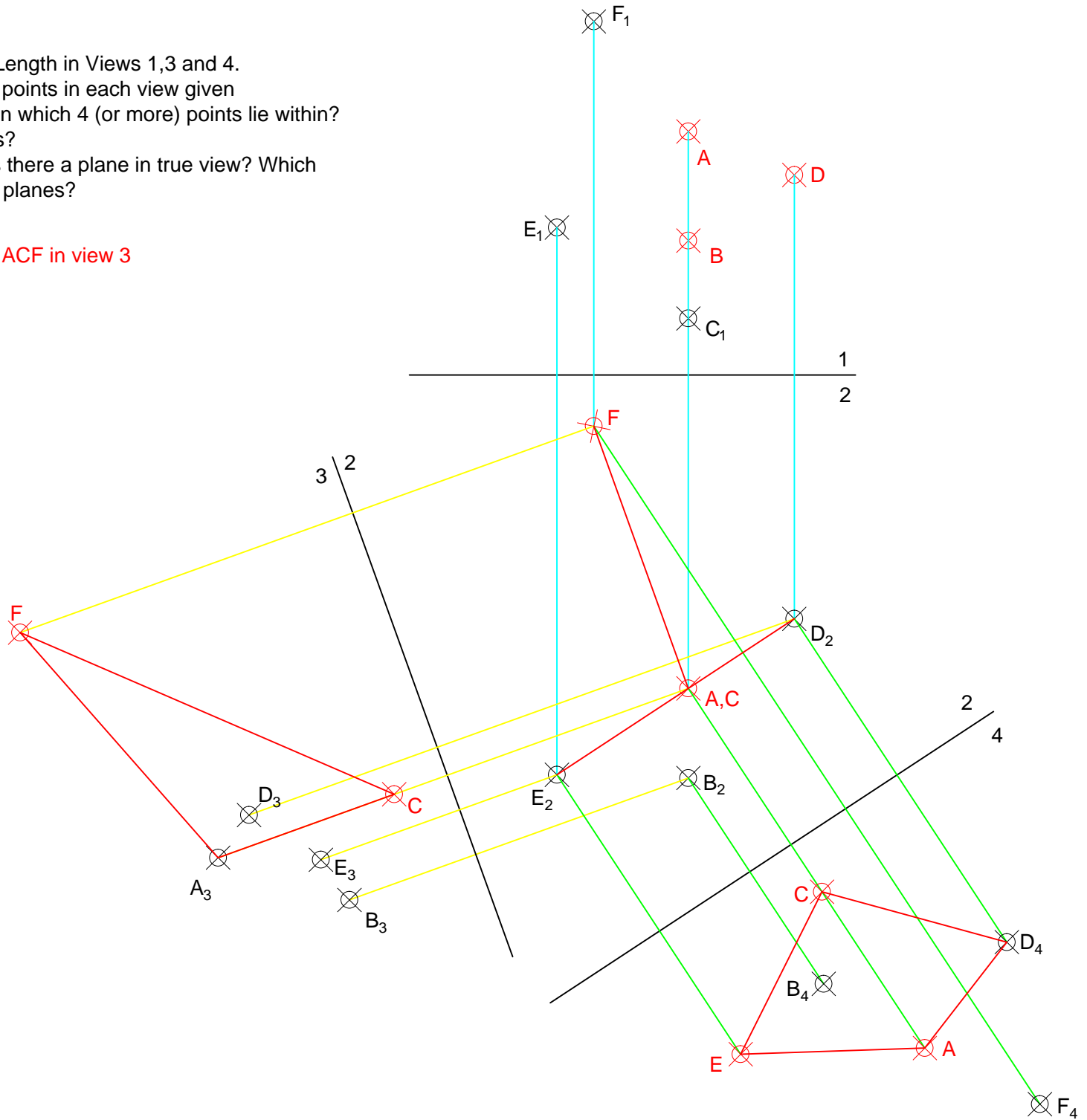

① Sketch a 4×5.5 rectangle and extrude .820

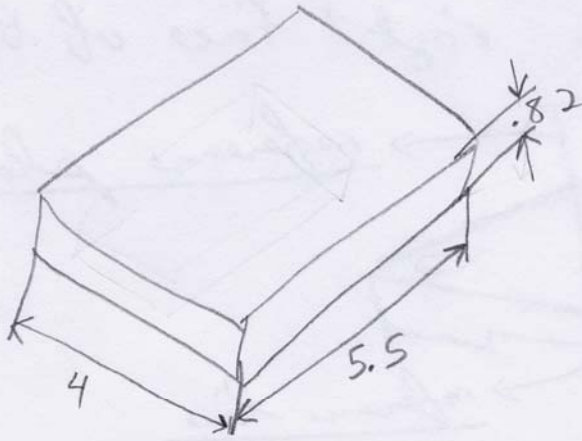

② Sketch 4 holes of diam .5 and at offset of 0.7 from corners, and extrude cut through all

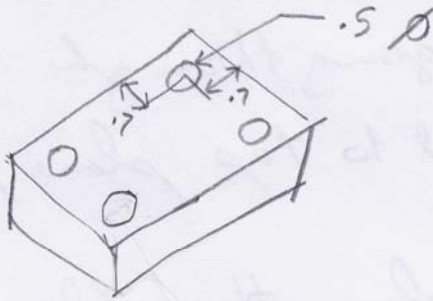

③ sketch a $1.6 \times .12$ rectangle on front face of part and extrude cut through all.

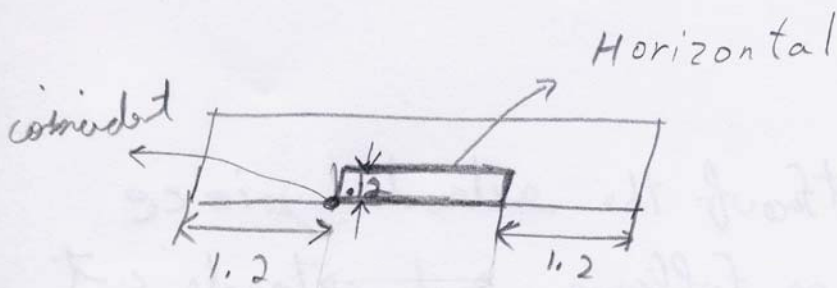

④ sketch a $3.1 \times .12$ rectangle on Right face of part and extrude cut through all

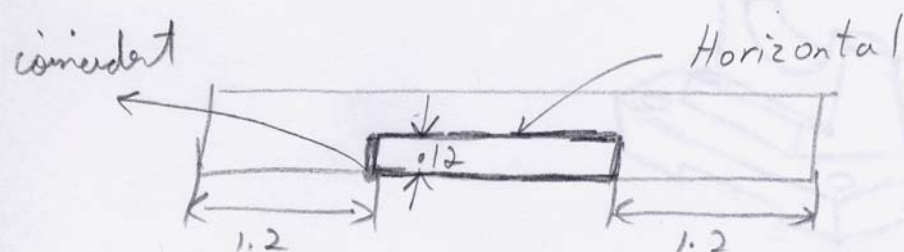

⑤ make a reference point "A" at 1.3 from front face and .8 from right face of Base part

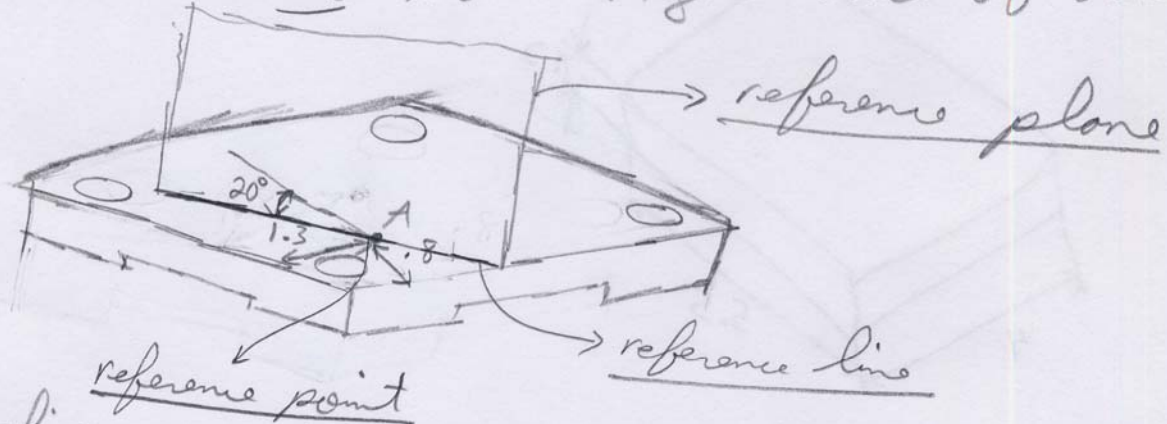

⑥ define a reference line going through pt "A", and at an angle of 20° with the front plane

⑦ define a reference plane going through the reference line and vertical (i.e. orthogonal to top plane)

⑧ sketch on the reference plane the following and extrude 3.5.

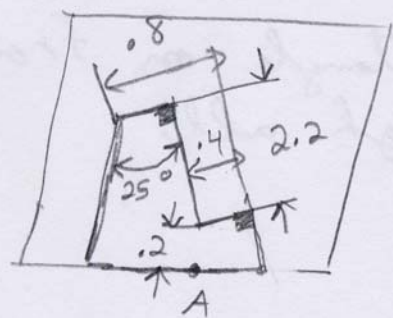

⑨ Select the top right face of the extruded piece and draw a circle as follows and extrude cut through all.

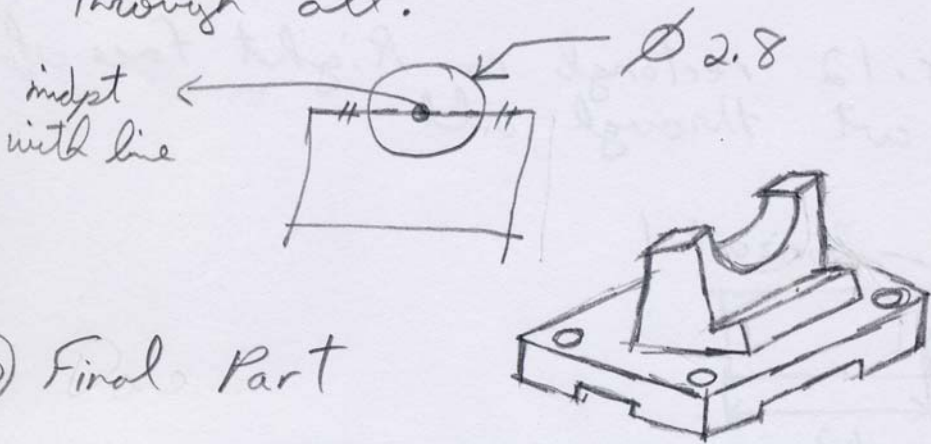

⑩ Final Part